

Plug-in 70mm DMC Control Plate Assembly Parts List

PRODUCT INFORMATION BULLETIN #3858

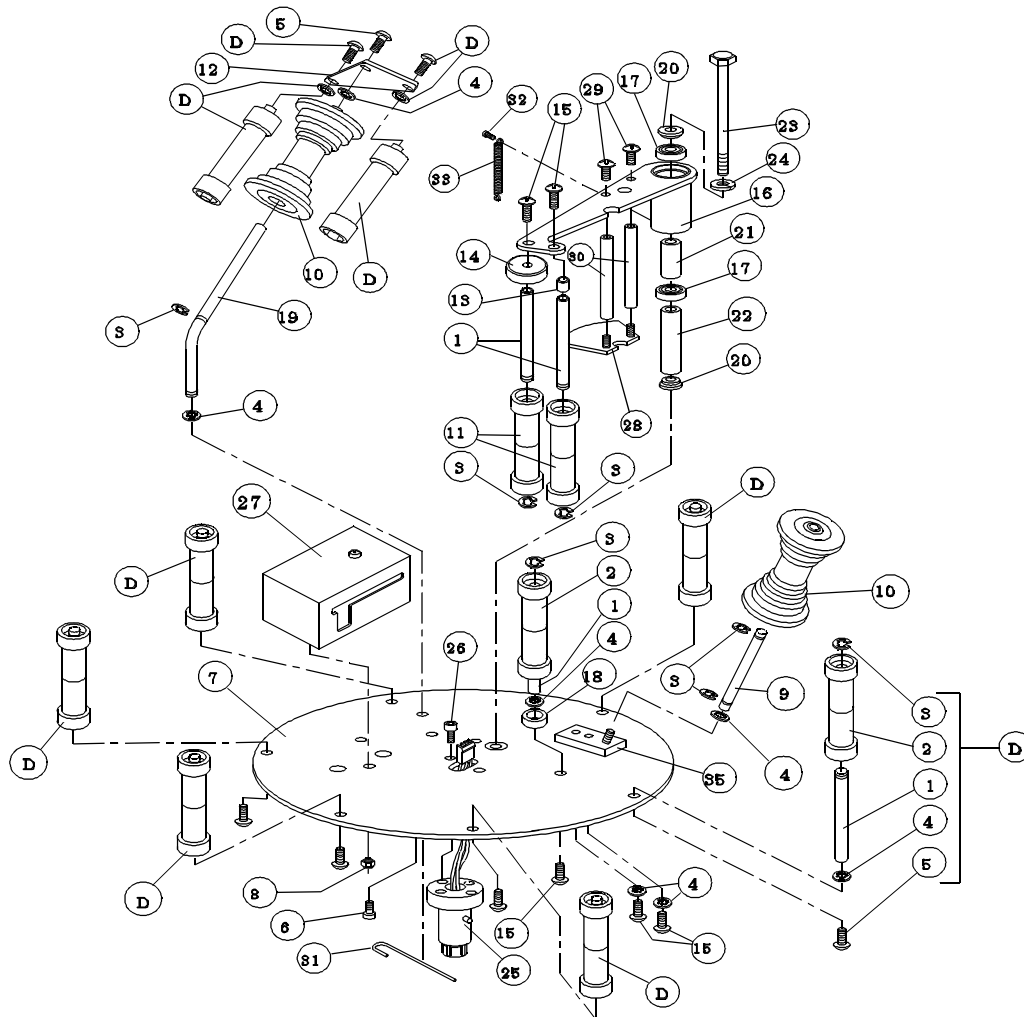

- | | |
|--|--|
| 3942 Control Plate Assy., Plug-In, 70mm DMC Complete | 18) 4301 Control Plate Feed Exit Spool Spacer, 70mm |
| D) 2876 Spool & Shaft Assy., 70mm (includes 1-5) | 19) 1658 Control Plate Exit Shaft #3, 5/16" Dia. 70mm |
| 1) 1431 Spool Shaft, 70mm | 20) 2380 Control Plate Sensor Arm Washer |
| 2) 1491 Spool Assembly, 70mm | 21) 2379 Control Plate Sensor Arm Spacer |
| 3) 1050 E-Ring, 5/16" | 22) 1742 Control Plate Arm Hub Standoff, 70mm |
| 4) 1078 Lockwasher, #10, Internal Tooth | 23) 3009 HHCS, 1/4-28 x 3 3/4" |
| 5) 1071 Screw PTH, 10-32 x 3/8" | 24) 1079 Lockwasher, 1/4" Split Ring |
| 6) 1592 SHCS, 10-32 x 1/2" | 25) 4364 Control Plate, Plug-In Adapter, DMC
(Includes item 26) |
| 7) 2210 Control Plate & Nut Sub Assy. 70mm | 26) 1064 SHCS, 8-32 x 3/8" |
| 8) 1032 Locknut, Nylon Insert, 4-40 | 27) 3358 Digital Motor Control (Control Plate) |
| 9) 1654 Pulley Shaft-Castor, 5/16" Dia. 70mm | 28) 2906 Control Plate Sensor Mask, DMC |
| 10) 1715 Pulley Assy. 5/16" ID, 70mm | 29) 1069 Screw, PTH, 8-32 x 3/8" |
| 11) 3067 Sensor Arm Spool Assy. 70mm | 30) 3952 Control Plate Mask Shaft, DMC, 70mm |
| 12) 1436 Control Plate Keeper Tab, 70mm | 31) 2171 Phase Control Mask Spring |
| 13) 1153 Control Plate Arm Spool Spacer Float | 32) 3353 SHCS, 2-56 x 1/4" |
| 14) 2006 Control Plate Arm Film Spacer | 33) 3338 Control Plate Arm Return Spring, DMC |
| 15) 1072 Screw, PTH, 10-32 x 1/2" | 35) 4323 Control Plate Angle Block, 70mm |
| 16) 3954 Control Plate Sensor Arm & Hub | |
| 17) 2407 Bearing, 5/8 OD x 1/4 ID | |